

TLC. | Hook clamps

Steel or stainless steel



STANDARD EXECUTIONS

- **TLC.Z**: zinc-plated steel.
- **TLC.SST**: AISI 304 stainless steel.

SPECIAL EXECUTIONS ON REQUEST

- Hook clamps in unplated steel or nickel-plated steel.
- Catch brackets in different shapes and finishes.

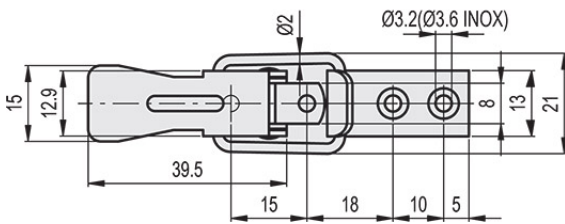
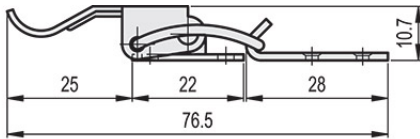

TLC.Z

METRIC

Code	Description	Max. working load [N]	Load at breakage [N]	⚖️
420071	TLC.Z-15/76.5+R	400	1000	16

TLC.SST

INOX STAINLESS STEEL METRIC

420072	TLC.SST-15/76.5+R	400	1500	16
--------	-------------------	-----	------	----

Latches

1222

